

Rotating Triac dimmer (2.4GHz)

Model No.: TRI-K1

Features

- Uses 2.4G wireless transmission technology
- 2.4G RF wireless remote control
- Smartphone app control (2.4GHz gateway is needed)
- Trailing edge phase-cut technology
- 0~100% stepless dimming and flicker free
- Lowest brightness setting function
- Built-in temperature detecting switch, over heat /loading protection
- Auto transmitting function, unlimited control distance
- Anti-fire PC shell is more safety
- Support Alexa, Google Assistant, Yandex Alice voice control (2.4GHz gateway is needed)



Parameters

| | | | |
|-------------------|------------------------|------------------------|------------------------------------------------------------------------------------|
| Name: | Rotating Triac dimmer | IP Rating: | IP20 |
| Model No.: | TRI-K1 | Working Temperature: | -10~40°C |
| Input Voltage: | 100-240V~ 50/60Hz | EMC Standard (EMC): | ETSI EN 301 489-1 V2.2.3(2019-11) ETSI EN 301 489-3 V2.3.2 (2023-01) |
| Output: | 100-240V~ | | |
| Output Current: | Max 1.36A | Safety Standard (LVD): | EN 61347-2-11: 2001+A1: 2019 EN 61347-1: 2015+A1:2021 EN 62493: 2015+A1:2022 |
| Output Power: | 150W @110V; 300W @220V | | |
| Protocol: | 2.4GHz RF | Radio Equipment (RED): | ETSI EN 300 440 V2.2.1 (2018-07) |
| Control Distance: | 30M | Certification: | CE, EMC, LVD, RED |

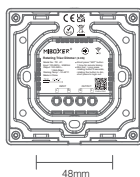
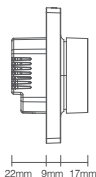
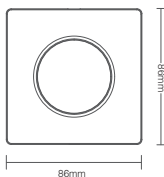

Connection Diagram

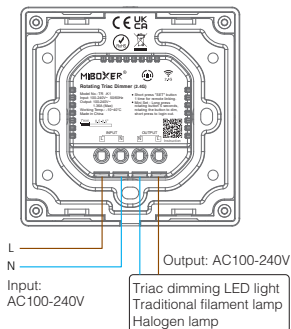

or

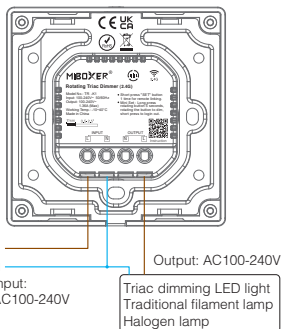

Installation Diagram

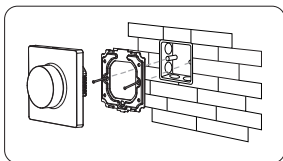

Fix the controller base on the bottom case with screw.

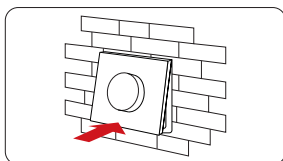

Clicks into the upper side of glass panel on the controller base, then press the lower side slightly to make it clicks into the controller base.

Remote Link

Triac dimmer can be connected with remote control

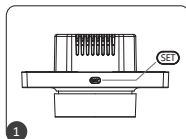

Short press "SET" button 1 time for remote linking.

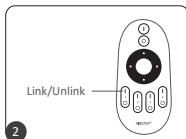

short press " | " 3 times within 3 seconds

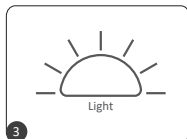

link is done once light flashes 3 times slowly



Link is failed if light doesn't flash, please repeat above steps
(Attention: can not link again if remote already finished linking)

Functional Description

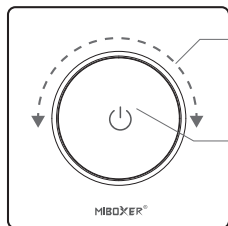

Rotate the knob to adjust brightness

- Short press the knob to turn the light on and off
- Press and hold the knob for 5 seconds until the indicator flashes to set the minimum brightness. Turn the knob to adjust to the appropriate brightness value and short press the knob to exit

“Breaker mode” is activated or shut down

Attention: It only support to turn on/off light, user can not dim device once this mode is activated

Turn On: short press “SET” 5 times quickly, mode had activated once indicator blink 3 times quickly

Turn Off: short press “SET” 5 times quickly, mode had shut down once indicator flash 3 times slowly

Auto transmitting (2.4G RF remote signal)

The controller can transmit remote signal to another controller automatically while the distance between lights are 30m, the remote control distance is unlimited. (Attention: all controllers must be linked with same remote)

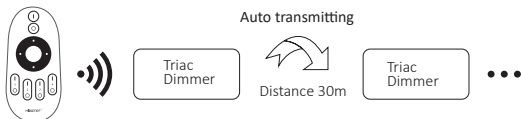

Compatible with these 2.4G RF remote controls (Purchased separately)

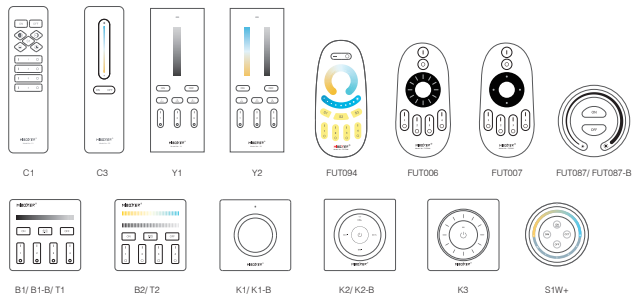

Attention

1. Please turn off power supply before installation.
2. Please ensure input voltage to be same as requirements from device.
3. Don't disassemble device if you are not expert, otherwise it will damage it.
4. Please do not use the light in the place with widely range metal area or strong electromagnetic wave nearby, otherwise, the remote distance will be seriously affected.



Made in China