

Connection Diagram

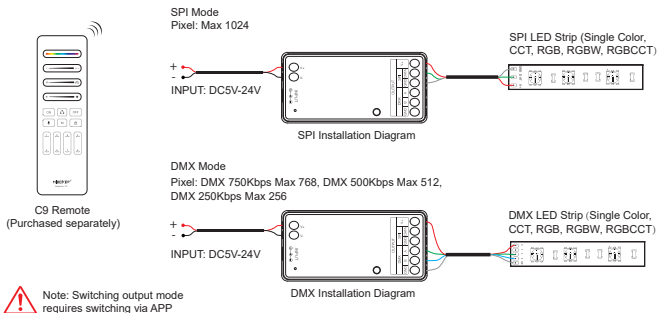

Application Diagram

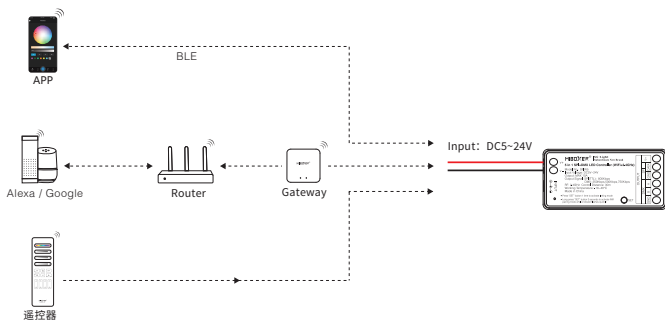

Compatible remote (purchase separately)



C9 SPI Remote

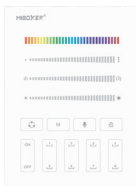

B9 SPI Panel Remote

Link/Unlink

1). Link

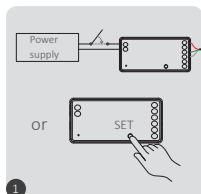

Power off 10 seconds and power on again or short press "SET"



Short press "ON" button 3 times within 3 seconds.

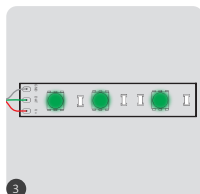

Green flashing state, then the code is successful.



Link is failed if light doesn't flash, please repeat above steps
(Attention: can not link again if remote already finished linking)

Unlink:

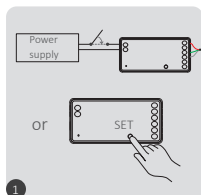

Power off 10 seconds and power on again or short press "SET"



Short press "ON" button 5 times within 3 seconds.

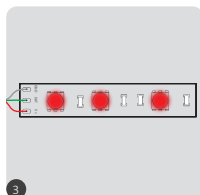

Red flashing state, Then clear the code successfully.



Unlink is failed if light doesn't flash, please repeat above steps
(Attention: no need to unlink if the light never be linked)

Smart Phone APP Control

Pairing Network (don't support 5G router)

1).Download and install "TUYA SMART" APP

search "TUYA SMART" in application store or scan QR code, please register account if using it in the first time, login into account if already have account



2).Pairing Network

Connect controller with mains

Ensure indicator flashes quickly(2 times per seconds)

You have 2 ways to correct indicator status

- Long press" SET" button

- Power off and power on controller 6 times

Connect phone with home wifi 2.4GHZ network

Open the APP interface, click "+"

Click "Lighting" and "Light source (BLE+Wifi)

Complete the rest steps

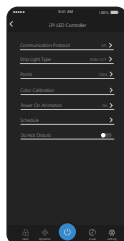
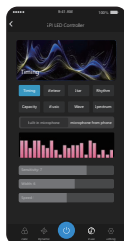
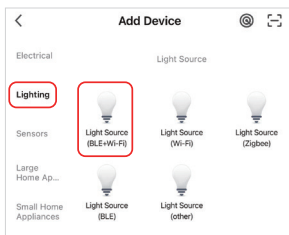
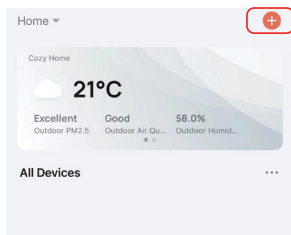

Function Instruction



APP

Static Mode

Adjust or save pure static illumination

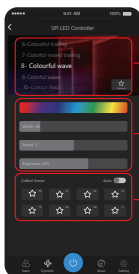

28 kinds of white color 80 kinds of rgb color

Change color, width, speed and brightness for all those modes

Save 8 scenes

For example, regarding as App

Dynamic Mode (select it via remote)

28 kinds of white color, 80 kinds of rgb color, save favorite modes and 8 scenes mode, all modes can change color ,brightness, width and speed

Music Mode

8 kinds of music mode work with internal microphone and smart phone microphone

Setting Communication Protocol

Setting it via APP

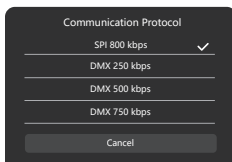
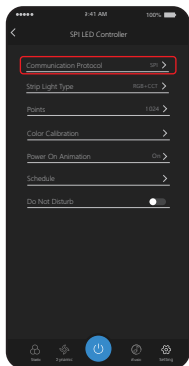

Select SPI or DMX protocol

Setting LED strip light

Change output based on different LED strip lights
like single color, cct, rgb, rgbw, rgb+cct

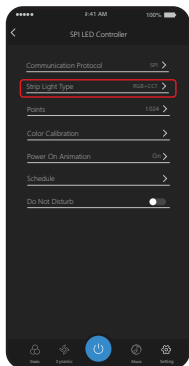

LED strip light types

Setting Pixel points

Setting it via program

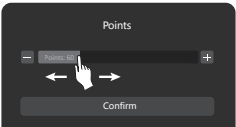
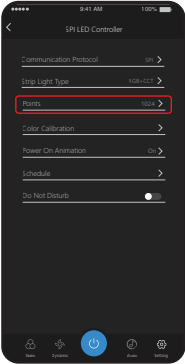

Slip the slider to change numbers

Color Calibration

Correct the color of led strip light via APP

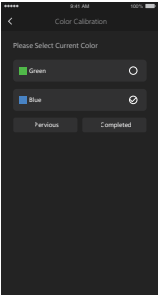
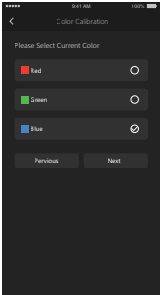
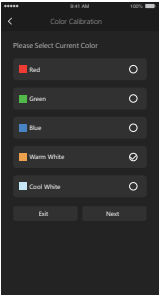

Following the tip to complete color calibration

Boot Animation

Setting color or color temperature, speed and brightness

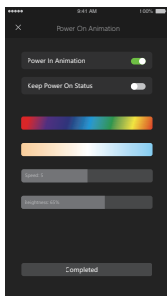

Timer Function

Setting it via APP

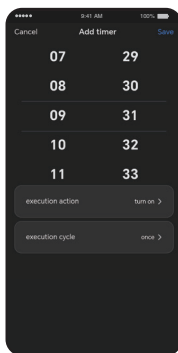
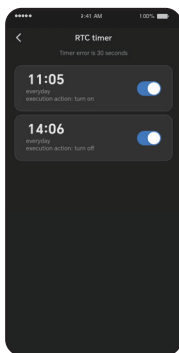
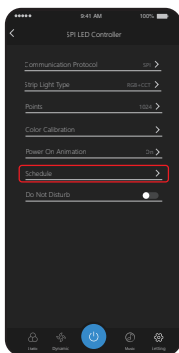

DND Mode ON/OFF

Turn on DND mode (usually using in power failure area to save power)

Alexa voice control instruction

Please add device into **[Tuya Smart]** app, then start following steps

- 1). Open Alexa App
- 2). Click "More" on the bottom of right corner
- 3). Click "Skills & Games"

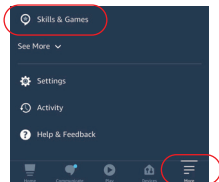

- 4). Click "Q" on the top of right corner
- 5). Type into "Smart life" and search



- 6). Click "Smart Life" skill, follow instruction to finish configuration and start voice control

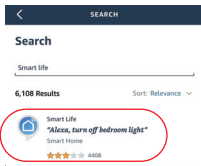

Google Home voice control instruction

Please add device into **[Tuya Smart]** app , then start following steps

- 1). Open Google Home App
- 2). Click “+” on the top of left corner

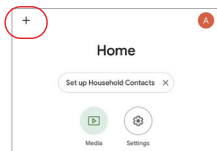

- 3). Click “Set up device”

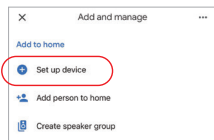

- 4). Click “Works with Google”

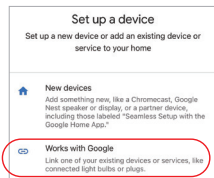

- 5). Click “Q” on the top of right corner
- 6). Type into “Smart life” and search
- 7). Click “Smart Life” skill, follow instruction to finish configuration and start voice control

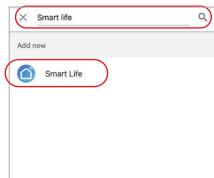

Attention

1. Please turn off power supply before installation.
2. Please ensure input voltage to be same as requirements from device.
3. Don't disassemble device if you are not expert, otherwise it will damage it.
4. Please do not use the light in the place with widely range metal area or strong electromagnetic wave nearby, otherwise, the remote distance will be seriously affected.



Made in China