

T Series: Powered by AC100~240V

Working Voltage: AC100~240V

Standby Power: 0.15W

Transmitting Power: 6dBm

Transmission Frequency: 2.4GHz

Working Temp.: -10~40°C

Control Distance: 30m

Size: 86*86*31mm

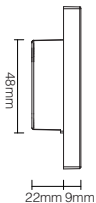
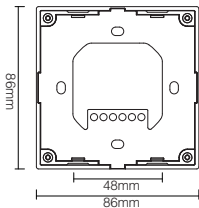

B2 & T2

4-Zone Panel Remote (Color Temp.)

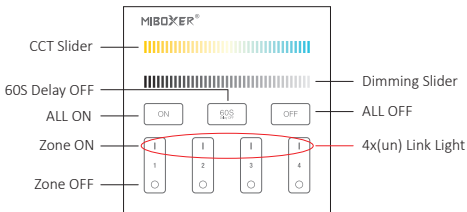



 Touch the slider to change color temperature.

 Touch dimming slider to change the brightness from 1~100%.

 Touch master ON, turn on all linked lights.
Long press 5 seconds to turn ON the indicating sound.

 When the light is ON, press "60S Delay OFF", the light will be OFF Automatically after 60 seconds.

 Touch master OFF, turn off all linked lights.
Long press 5 seconds to turn OFF the indicating sound.

 Touch Zone ON, turn on zone-linked lights.

 Touch Zone OFF, turn off zone-linked lights.

B3 & B3-B & T3 4-Zone Panel Remote (RGBW)

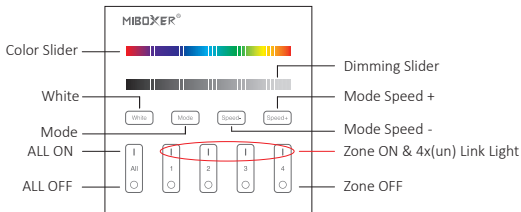

 Touch color slider, choose the color you want.

 Touch dimming slider to change the brightness from 1~100%.

 Touch white button to white light mode.

 Switching modes.

 Slow the speed on present dynamic mode.

 Accelerate the speed on present dynamic mode.

 **ALL ON:** Touch to turn on all linked lights.
Long press 5 seconds to turn ON the indicating sound.
Zone(1-4) ON: Touch zone ON, turn on zone-linked lights.

 **ALL OFF:** Touch to turn off all linked lights.
Long press 5 seconds to turn OFF the indicating sound.
Zone(1-4) OFF: Touch zone OFF, turn off zone-linked lights.

B4 & B4-B & T4 4-Zone Panel Remote (RGB+CCT)

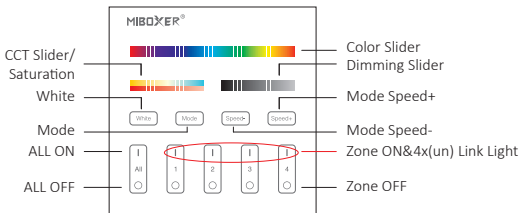

Touch color slider, choose the color you want.



Under white light mode, adjust color temperature;
Under color light mode, change color saturation.



Touch dimming slider to change the brightness from 1~100%.



Touch white button to white light mode.



Switching modes.



Slow the speed on present dynamic mode.



Accelerate the speed on present dynamic mode.



ALL ON: Touch to turn on all linked lights.

Long press 5 seconds to turn ON the indicating sound.

Zone(1-4) ON: Touch zone ON, turn on zone-linked lights.



ALL OFF: Touch to turn off all linked lights.

Long press 5 seconds to turn OFF the indicating sound.

Zone(1-4) OFF: Touch zone OFF, turn off zone-linked lights.

5. Installation

B series Installation

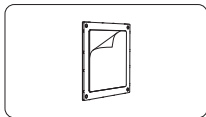

1. Tear out the back tape.

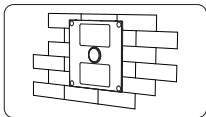

2. Stick the holder on the position where you want.

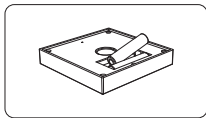

3. Install 2*AAA battery.

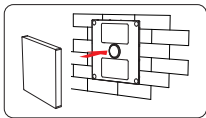

4. Put the rotating switch on the front of holder.

T series Installation/ Dismantlement

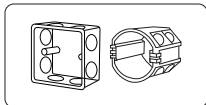

Install the bottom case into the wall;
Above are the standard bottom cases.

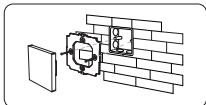

Fix the controller base on the bottom
case with screw.

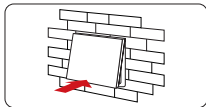

Clicks into the upper side of glass panel on
the controller base, then press the lower
side slightly to make it clicks into the
controller base.

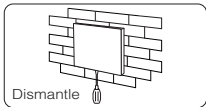

Dismantle

Plug into the below bayonet with a
screwdriver, and upwarp screwdriver,
then you can dismantle the controller.

6. Attention

1. Please check the cable, and make the circuit is correct before power on.
2. When installation, pls handle with care to avoid the broken of the T series glass panel.
3. Please do not use lighting fixtures around the mental area and high magnetic field, otherwise, it will badly affect the control distance.



Made in China