

AC Triac Dimmer (Zigbee 3.0 + 2.4G + Push)

Model No.: TRI-C1ZR

Features

- Zigbee 3.0 standard protocol
- Smartphone APP control (need to buy Zigbee 3.0 gateway)
- 2.4G RF wireless remote control
- Push dimming function
- Trailing edge phase-cut technology
- 0~100% stepless dimming and flicker free
- Lowest brightness setting function
- Built-in temperature detecting switch, over heat / loading protection
- Auto transmitting function, unlimited control distance
- Screw connector is reliable and easy to do installation
- Anti-fire PC shell is more safety



Parameters

Name: AC Triac Dimmer	IP Rating:	IP20
Model No.: TRI-C1ZR	Working Temperature:	-10~40°C
Input Voltage: 100-240V~ 50/60Hz	EMC Standard (EMC):	ETSI EN 301 489-1 V2.2.3(2019-11) ETSI EN 301 489-3 V2.3.2 (2023-01)
Output: 100-240V~	Safety Standard (LVD):	EN 61347-2-11: 2001+A1: 2019 EN 61347-1: 2015+A1: 2021 EN 62493: 2015+A1: 2022
Output Current: Max 1.36A	Radio Equipment (RED):	ETSI EN 300 440 V2.2.1 (2018-07)
Output Power: 150W @110V; 300W @220V	Certification:	CE, EMC, LVD, RED
Protocol: Zigbee 3.0/ 2.4GHz RF		
Control Distance: Zigbee: 100M(open area) 2.4G: 30M		

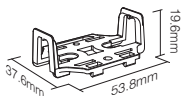
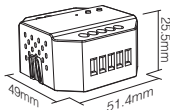

Connection Diagram

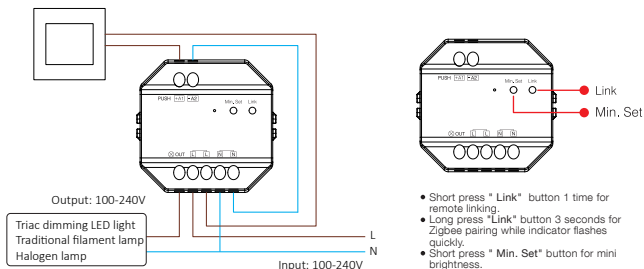

Installation Diagram

Support following standing junction box

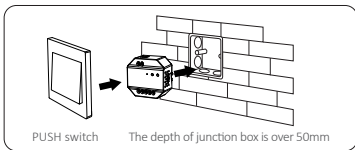
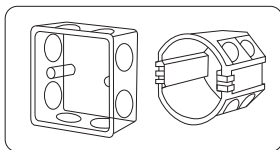

Please use plastic junction box for installation, the metal type have barrier for signal transmission

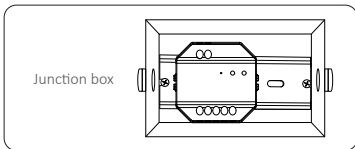
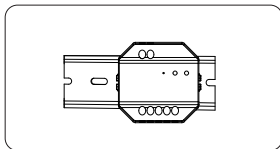

PUSH Dimming

Short press PUSH switch:

Turn ON/OFF light

Long press PUSH switch:

- Stepless dimming brightness.
- Long press and release your finger, then repeat long pressing to increase or decrease brightness
- Please long press switch 20 seconds until all lights have same brightness with 100% level if multi dimmers had connect with same self-return switch. The quantity of dimmers which connect with same self-return switch can not be over 25 pieces, the connection cable of self-return switch can not be over 20m.

Various control solution:



Compatible with these 2.4G RF remote controls (Purchased separately)

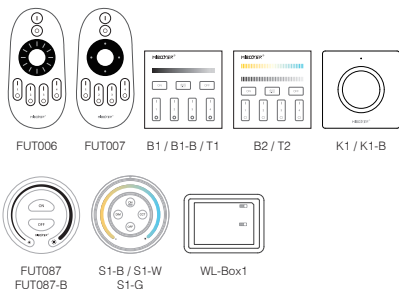

Auto transmitting (2.4G RF remote signal)

The controller can transmit remote signal to another controller automatically while the distance between lights are 30m, the remote control distance is unlimited.
(Attention: all controllers must be linked with same remote)

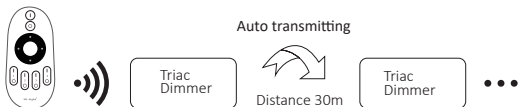

2.4G RF Remote control instruction

Linking Code Instructions

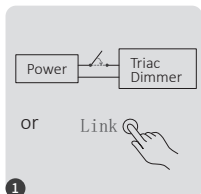

Power off 10 seconds and power on again or short press "Link" one time

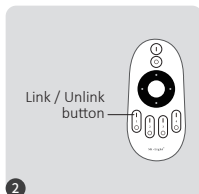

Short press " I " button 3 times within 3 seconds.

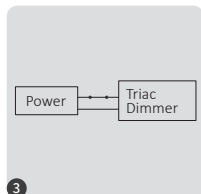

Lights blink 3 times slowly means linking is done successfully.



Linking failed if light is not blinking slowly, Please follow above steps again. (Note: Light that have linked can't link again)

Unlinking Code Instructions

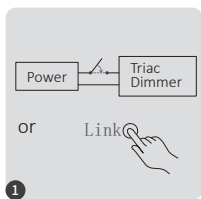

Power off 10 seconds and power on again or short press "Link" one time

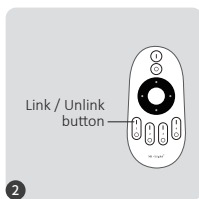

Short press " I " button 5 times within 3 seconds.

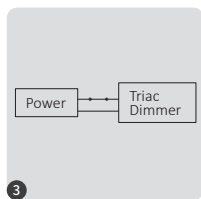

Lights blink 10 times quickly means unlinking is done successfully.



Unlinking failed if light is not blinking quickly, Please follow above steps again. (Note: Light haven't linked that don't need to unlink)

Smartphone APP control instruction

Added Zigbee 3.0 gateway into “Tuya Smart” App (please review instruction of Zigbee 3.0 gateway)

- 1). Connect with power supply.
- 2). Pairing network (**attention: factory default is pairing network**).

Way one: Turn off and turn on light 6 times or over 6 times continuously, the light is in breathing status.

Way two: Long press “ Link ” key until indicator light flashing.

- 3). Open “Tuya Smart” APP to click Zigbee gateway, then click “Add sub device”.
- 4). Click “Indicator is flashing quickly”.
- 5). Support APP dimming or group control and etc once added successfully.

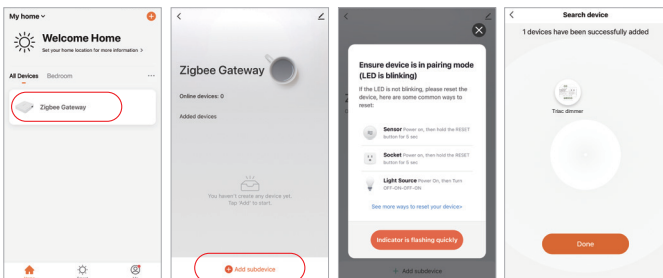

App turn on and off “Do Not Disturb” mode (default activated)

Click the light which need to be set up or group control --- click “More” --- click “Power-on behavior” --- turn on or off

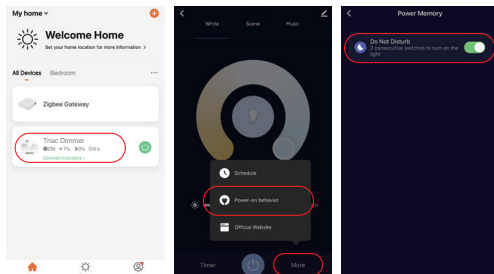

Philips Hue control instruction

Added "Philips Hue" into APP

- 1). Connect with power supply
- 2). Pairing network (**attention: factory default is pairing network**)
Way one: Turn off and turn on light 6 times or over 6 times continuously, the light is in breathing status.
Way two: Long press " Link " key until indicator light flashing.
- 3). Open "Philips Hue" App to click "SETTINGS" and click "Lights"
- 4). Click "+" on the top of right corner
- 5). Click "Search"
- 6). Click "Start configuration", Follow the app instruction to complete configuration

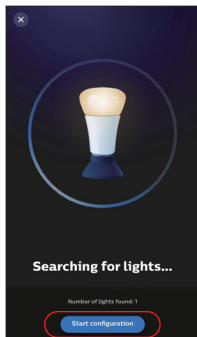
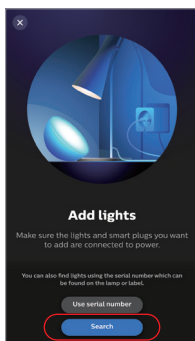
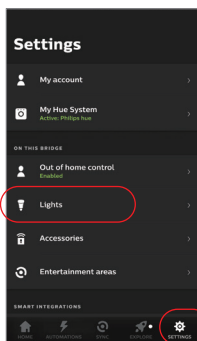

Alexa voice control instruction

1). Alexa control (Audio support Zigbee 3.0 protocol)

You can connect directly if your Amazon ECHO already is built-in zigbee 3.0 protocol, following model with zigbee 3.0 protocol:

Amazon ECHO Plus (2nd Gen), ECHO (4th Gen), ECHO Studio, ECHO Show (2. Gen)

- 1). Connect with power supply
- 2). Pairing network (**attention: factory default is pairing network**)

Way one: Turn off and turn on light 6 times or over 6 times continuously, the light is in breathing status.

Way two: Long press " Link " key until indicator light flashing.

- 3). Say to Amazon ECHO "Alexa, Discover devices"
Wait for a while to discover device, Voice control is activated



2). Alexa control (Audio don't support Zigbee 3.0 protocol)

Please add device into Miboxer Zigbee 3.0 gateway if your Alexa don't support zigbee 3.0 protocol, then start following steps

- 1). Open Alexa App
- 2). Click "More" on the bottom of right corner
- 3). Click "Skills & Games"

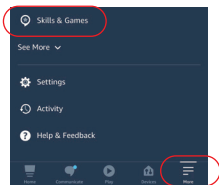

- 4). Click "Q" on the top of right corner
- 5). Type into "Smart life" and search



- 6). Click "Smart Life" skill, follow instruction to finish configuration and start voice control

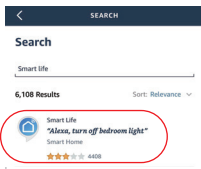

Google Home voice control instruction

Please add device into MiBoxer Zigbee 3.0 gateway and start following steps

- 1). Open Google Home App
- 2). Click “+” on the top of left corner

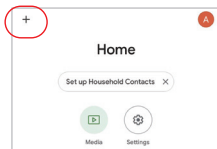

- 3). Click “Set up device”

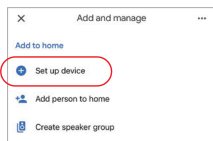

- 4). Click “Works with Google”

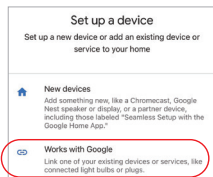

- 5). Click “Q” on the top of right corner
- 6). Type into “Smart life” and search
- 7). Click “Smart Life” skill, follow instruction to finish configuration and start voice control

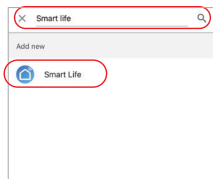

Attention

1. Please turn off power supply before installation.
2. Please ensure input voltage to be same as requirements from device.
3. Don't disassemble device if you are not expert, otherwise it will damage it.
4. Please do not use the light in the place with widely range metal area or strong electromagnetic wave nearby, otherwise, the remote distance will be seriously affected.



Made in China